

TEECO

Topics



HONOR • INTEGRITY • COMMITMENT

Jan - Feb - Mar 2010

News, Information and Products for the LP-Gas Equipment Professional

HAPPY NEW YEAR

Teeco's Online B2B System

Have you visited www.teecoproducts.com lately? Discover the numerous benefits to using our online B2B system:

Simple to use - Set up is easy. All you need is a Teeco Account Number and an email address. Once you're set up, simply access your account using your email address and your password.

Shop your way - You can easily customize (and expedite!) your shopping experience by creating Favorites Lists and utilizing our Quick Order Pad.

Find information in a snap - Whether you're online to order or to browse, you can retrieve useful information on your Teeco account such as order history, orders in process, open invoices and more. And best of all, it's available 24/7!

Free Freight on online orders of \$975 or more - A quick and easy way to save money on freight. (Some restrictions apply, so see our website for details.)

If you're new to online ordering, call your Teeco representative or your local Teeco office and they'll be happy to give you a hand.



See Inside:

Message From The President	Page 2
Fugitive Emissions Reduction Rebates	Page 3
Teeco Tech	Page 4
WPERC Regulator Rebate Program	Page 5
Smith Pumps Core Exchange Program	Page 6
Bosch Tankless Water Heaters	Page 7
What Is This Product?	Page 8

Support Your LP Gas Industry

Looking back on 2009, we have had many opportunities to be involved in the LP Gas Industry beyond our day to day functions. From the National Convention in Atlanta and exhibiting in various State Association events, such as the Western, Northwest, Colorado/New Mexico and South Dakota conventions, to providing educational opportunities for our customers, staying involved in industry activities remains a high priority.

Education

Teeco's customers attended a Corken Pump Service class in our Auburn, WA location where they received hands-on training by George Jenkins of Corken. Other sessions offered by Teeco this past year include Smith Pump Classes presented by John Ives, as well as RegO Regulator and Continental Con-Stub training.

Teeco Sacramento was also home to a series of CETP classes over the summer months.



Association Involvement

Teeco serves on the Executive Boards of both the National Propane Gas Association and the Western Propane Gas Association and attended Propane Days in June, where propane industry leaders had opportunities to meet with State and Local government officials regarding issues affecting our industry.

Teeco also maintains membership in many of the associations that serve our customers. Below are just few of the Industry Associations Teeco proudly supports.



Quality LP Gas Products from a Company You Can Trust

Message from the President



By Dwaine Goodwin
President,
TEECO Products, Inc.

2009 is over! Thank you very much! Now, hopefully, 2010 begins and we look to a new beginning and a prosperous year ahead.

Looking back at 2009 does allow us to reflect on many good things that exist in our industry. We, Teeco, are

We, Teeco, are blessed to have so many good friends as customers and suppliers, many of whom have been in business 40, 50, 60, 70 or even 100 years.

blessed to have so many good friends as customers and suppliers, many of whom have been in business 40, 50, 60, 70 or even 100 years. Some of our friends are second, third or even fourth generation.

We know 2009 was difficult for most of our customers, if not all; market instability, product pricing with wide fluctuations and customer-users with real

concern about their own economies. We recognize all of these and can appreciate the results in 2009. We also are confident that 2010 will once again bring a change for the better as we begin the difficult, but necessary, efforts to put our own businesses back on a course of growth and profitability. It will be, as always, a challenge, but not one that our industry has not faced previously.

Teeco Products continues to be here for our customers and suppliers. We are dedicated and committed to the mutual success of all and will continue to provide the very best in quality equipment and service at a fair price.

Again, thank you for your continued support and please enjoy a prosperous 2010.



Inside TEECO

Willard Eugene "Bud" Bailey, Jr.

Teeco has lost a dear member of its extended family. On November 24, 2009, W.E. "Bud" Bailey, father of Teeco's Bob Bailey, passed away. Bud was born July 2, 1923 in Marysville, CA. Nearly 200 were in attendance at his funeral service.

Bud joined the Army during World War II and manned a radio during the Battle of the Bulge in Europe. When he returned home from the war, he put himself through Mortuary Science School and returned to Clark, Booth and Yardley Funeral Home, where he had worked before the war. He later joined the AJ Nicoletti Funeral Home, and was eventually left the business by the Nicoletti family.

Bud had a great sense of humor and enjoyed many activities with his family over the years. He loved attending baseball games, bowling, golfing, playing cards, camping and fishing, and was involved in the Scouts with all three of his sons. He was devoted to his family and proudly boasted their every achievement.

He saw the goodness in people and believed that hard work and respect were the keys to success. Bud passed away in Sacramento at the age of 86. He was preceded in death by his daughter Sharron Roberts and is survived by his wife Rose and his three sons, Bill, Bob and Barry.

"You could put him in a room for five minutes with someone and he'd know them - he never met a stranger. He lived a good life." -Rose Bailey

TEECO Topics is published four times yearly by TEECO Products, Inc. as a service to our customers. 3,000 copies are distributed to customers and selected LPG industry leaders.

President

Dwaine Goodwin

Vice President, Operations

Bob Bailey

Vice President, Administration and Finance

Gary Childress

Marketing Manager

Mary Clements

Regional Sales Manager, Central/Southern California and Southern Arizona

Dave Cox

Operations Manager, Sacramento, CA

Tom Valverde

Regional Sales Manager, Pacific Northwest/Northern California

Dave Drimmel

Operations Manager, Auburn, WA

Charles Banks

Regional Sales Manager, Rocky Mountains-North

Bob Page

Regional Sales Manager, Rocky Mountains-South, Northern AZ

Ewing Jenks

Operations Manager, Rapid City, SD

Mike Beck

Engineering, Construction & Fabrication Manager

Paul Connelly

Fabrication Manager

Jay Stephens

TEECO Corporate Headquarters

16881 Armstrong Avenue
Irvine, CA 92606
(800) 854-3463
or (949) 261-6295
FAX (888) 854-3463



Sales and Service

TEECO Sacramento, CA Superstore

Sales, Fabrication, Engineering & Construction
7471 Reese Road
Sacramento, CA 95828
(800) 225-6621 or (916) 688-3535
FAX: (888) 225-6621 or (916) 689-1219

TEECO Rapid City, SD

414 E. Blvd. N.
Rapid City, SD 57701
(800) 843-8660 or (605) 342-2802
FAX (888) 843-8660 or (605) 342-4942

TEECO Auburn, WA

1601 Pike Street N.W.
Auburn, WA 98001
(800) 426-9456 or (253) 735-0222
FAX (888) 426-9456 or (253) 735-1008

Website: www.teecoproducts.com

e-mail: info@teecoproducts.com

Free Freight on Online Orders of \$975 or More

visit www.teecoproducts.com for details

Continental Flex Risers

Service Head Adapter Flexible Risers

Specifically designed for use with LP-Gas tanks. Flexible risers easily wrap around tanks, making for smooth installations.

Teeco also carries Anodeless Risers and a wide range of Fittings from Continental.

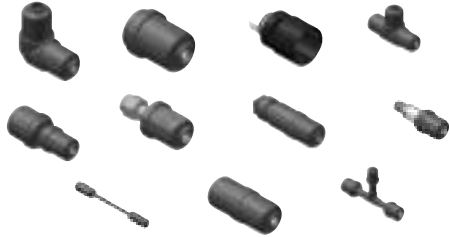

Continental Flex Riser Specifications

Part #	Size (MPT x PE)	Wall	Length
1253-92-1004-36	1/2" NPT X 1/2" CTS .090	.090	36"
1253-92-1004-48	1/2" NPT X 1/2" CTS .090	.090	48"
1253-92-1004-84	1/2" NPT X 1/2" CTS .090	.090	84"
1353-92-1004-36	3/4" NPT X 1/2" CTS .090	.090	36"
1353-92-1004-48	3/4" NPT X 1/2" CTS .090	.090	48"
1353-92-1004-84	3/4" NPT X 1/2" CTS .090	.090	84"
1353-92-1013-36	3/4" NPT X 3/4" IPS SDR-11	SDR-11	36"
1353-92-1013-48	3/4" NPT X 3/4" IPS SDR-11	SDR-11	48"
1353-92-1013-60	3/4" NPT X 3/4" IPS SDR-11	SDR-11	60"

NEW at TEECO

Presto-Tap: The Propane Safety Company

As a RegO Master Distributor, Teeco Products will be carrying Presto-Tap products. Presto-Tap, LLC is committed to engineering innovative, safety-focused products to serve the LP-Gas Industry. Their UL listed Presto-Tap Leak Detection System line of products offers an efficient way for drivers to test for leaks, obtain pressure readings and confirm the presence of gas in LP tanks.

Their easy-to-use system requires no special tools and only minimal training, so drivers and servicemen can easily comply with industry-mandated leak detection and documentation procedures.

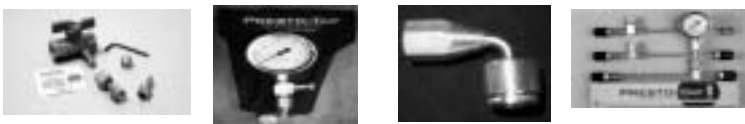

Presto-Tap products meet NFPA 54 and 58 specifications

WPERC Fugitive Emissions Reduction Rebate Program

Are you ready to purchase low-emission equipment for your operation in California? Apply to receive a **75% rebate on the cost of equipment** through this special Western Propane Education & Research Council program. Eligible applications from marketers or transporters based in California are for removal of existing equipment and replacement with new, low-emission equipment in 2010. \$150,000 has been allocated for this program. Rebates are offered on a first-come, first-served basis. For program requirements and application forms, contact WPERC at (916) 447-9742.



Quick Acting Minimum Loss Hose End Valves for Bobtail Delivery Trucks and Dispensing Stations



LOW EMISSION!



Designed to vastly reduce the amount of product vented when disconnecting bobtail delivery trucks, dispensing systems and anhydrous ammonia nurse tanks. These valves provide instant, full-on flow at the flip of a handle. Shut-off is instant and the handle locks for added protection. This top of the line hose-end valve is a fully contained unit that does not require additional filling adapters or connectors.

Part #	Inlet Connection (F.NPT)	Outlet Connection (F.ACME)	Locking Handle	Flow at 1 PSIG (Cv) Pressure Drop* (GPM/Propane)
A7793A	3/4"	1 3/4"	Yes	16.0
A7797A	1 3/4"	1 3/4"		16.0

Above items are included in WPERC Fugitive Emissions Reduction Rebate Program. See top of page for details.

RegO Valves

Teeco carries a full line of RegO valves to handle all your needs.

RegO valves come with a 10 year limited warranty.



NEW at TEECO

Float Gauge Drill Guide

The Float Gauge Drill Guide is a precision tool, designed to precisely guide the drill bit through the center of broken float gauge screws.



Part #	Description
JR-DG	Junior Drill Guide
SR-DG	Senior Drill Guide

TEECO Tech

Float Gauge Drill Guide Instructions

Safety:

- Always wear Safety Glasses.
- Make sure the tank is empty and free of Flammable Gas vapors before attempting any repairs.
- Know and follow all of your company's safety policies and guidelines before proceeding.
- The Drill Guide should only be used by trained, qualified propane service technicians.

Recommendations:

- Always replace and use new gauge screws and gaskets supplied by the gauge manufacturers.
- Only use the proper drill bit size that is stamped on Drill Guide.
- Only use sharp drill bits.
- Anti-seize thread compound is highly recommended on the new gauge screws when reinstalling the float gauge.
- Only use sharp rethreading tools.
- Never use easy-out tools.

Instructions:

1. Place Drill Guide over broken screw to be drilled out using the small pilot bushing first.
2. To avoid drilling too deep use a small drill bit to measure the depth in a different screw hole.
(The holes are known as blind holes and drilling too deep will damage the gauge adapter permanently.) See diagram to the right.
3. Mark the drill bit used for the pilot hole to avoid drilling too deep.
4. Attach Drill Guide with two screws to the gauge adapter.
5. Drill out the center of the broken screw to the proper depth.
6. Remove the two screws and rotate the Drill Guide so the larger bushing is now over the broken screw.
7. Now mark the larger drill bit to avoid drilling too deep.
8. Attach Drill Guide with two screws to the gauge adapter.
9. Drill out the rest of the broken screw to the proper depth.
10. Remove Drill Guide and store in a clean dry place for future use.
11. Get proper tap for the screw to be used and rethread the hole.

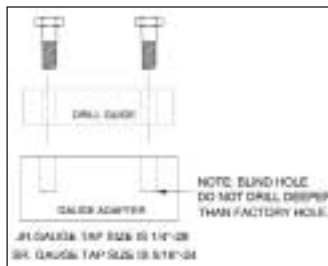

Above Instructions provided courtesy of Hoss Products

L.B. White - Tradesman

Portable Forced Air Heaters

High temperature output for small to large construction sites. Variable heat output. Electronic ignition, continuous self-diagnostics (on ULTRA models), heavy duty construction, 1 year warranty. CSA models certified for USA and/or Canada.

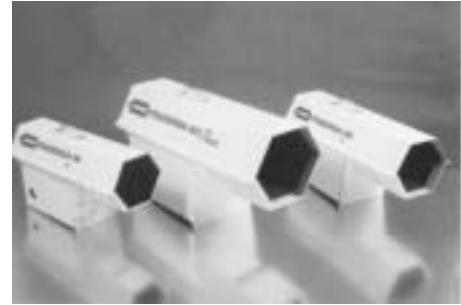

Part #	BTU/hr	Heated Air Output (CFM)	Fuel Type	Electrical Supply
T100	50,000-100,000	400	LP-Gas	115 VAC
T155			LP-Gas	
T155N			Natural Gas	
T155ULTRA*			LP-Gas	
T155NULTRA*			Natural Gas	
T400	200,000-400,000	1530	LP-Gas	
T400ULTRA*			LP-Gas	

* Self diagnostic system

Detroit Radiant

P Series Radiant Heaters

Ceramic burner. Aluminum reflector. Adjustable cylinder mounting bracket. UL listed single tank pressure regulator and high pressure hose. Excess flow check POL fitting. AGA listed manual shut-off. AGA and UL listed 100% shutoff safety gas valve. Main burner flame sensor. All models features tip over check. Cylinder not included.

Model P-16T, rated at 16,000 BTU, operates thirty hours on a 20 lb. propane cylinder. Model P-32T is rated at 32,000 BTU and operates fifteen hours on a 20 lb. propane cylinder.



Part #	Description
P-16T	Portable infrared heater, 16,000 btu
P-32T	Portable infrared heater, 32,000 btu

WPERC Regulator Rebate Program

The Western Propane Education & Research Council (WPERC) has allotted \$50,000 for the 2010 calendar year to provide rebates of \$20 per regulator for eligible removal of an existing single stage or two stage regulator system, and replacement with a new, unused twin or two-stage regulator system within the state of California. To be eligible, regulators must be replaced for an existing customer, and be 15 years old or older and in service at the time of replacement. Installations must be performed by a propane company, not the customer.

Contact WPERC at 916-447-9742 for Rebate Application and complete Program Guidelines.



Two Stage & Twin Stage Regulators



Two Stage Regulators



1st Stage Regulator		2nd Stage Regulator		Capacity BTU/hr LPG
Part #	Inlet x Outlet Female	Part #	Inlet x Outlet F. NPT	
LV4403TR9	POL x 1/2" NPT	LV4403B4	1/2" x 1/2"	935,000
		LV4403B46R	1/2" x 3/4"	
LV4403TR96	POL x 3/4" NPT	LV4403B466R	3/4" x 3/4"	

2 PSIG Delivery Pressure Twin Stage Regulator

Designed to reduce container pressure down to 2 PSIG. A line pressure regulator is required downstream to reduce the 2 PSIG to a normal 11" w.c.



Part #	Inlet Connection	Outlet Connection	Capacity BTU/hr LPG
LV404Y9	F. POL (CGA 510)	1/2" F. NPT	800,000

Compact Twin Stage Regulators

Up to 525,000 BTU/hr

Designed to reduce container pressure down to 11" w.c. delivery pressure. Ideal for "on-site" cylinder applications, mobile homes and average domestic service, including small ASME and 100 to 420 lb DOT cylinders.



Part #	Inlet Connection	Outlet Connection	Vapor Capacity BTU/hr LPG
LV404B4	1/4" F. NPT	1/2" F.NPT	525,000
LV404B4V9		3/4" F. NPT	
LV404B46			
LV404B46V9			
LV404B9	F. POL	1/2" F. NPT	
LV404B9V9		3/4" F. NPT	
LV404B96			
LV404B96V9			

Compact Twin Stage Regulators

Up to 200,000 BTU/hr

Designed for small domestic applications with flow requirements up to 200,000 BTU/hr. Ideal for mobile homes, cottages and "on-site" cylinder applications and can also be used in RV applications if a protective cover is applied.



Part #	Inlet Connection	Outlet Connection	Vapor Capacity BTU/hr LPG
LV404B23	1/4" F. NPT	1/2" F. NPT	200,000
LV404B29	F. POL		
LV404B23V9	1/4" F. NPT		
LV404B29V9	F. POL		

Free Freight on Online Orders of \$975 or More
visit www.tecoproducts.com for details



Core exchange program

Turn in your old pump for credit on a new SMITH Pump.

All exchanges are based on model for model, on a one-on-one basis.

Pump Exchange only. Motor not included.

Pump Models Included	
DW-1X	TC-2X
DW-HX	TC-2FX
ECH-1X	TC-1044HX
EG-1X	E-100X
GC-1X	E-100HX
MC-1X	MC-100X
MC-2X	MC-101X
MC-3X	MC-102X
MC-4X	MC-102QX
MC-5X	MC-103X
MC-1044X	MC-104X
MC-1044HX	MC-105X



D-Series

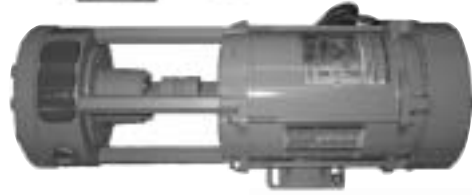

E-Series



MC-1, GC-1

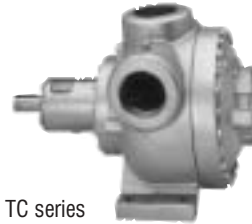

TC series



MC-3



MC-5



MC-4

The Next Generation Teeco Saf-T-Lok

The Very Best Protection for the Lowest Possible Cost

Are you losing time and money due to non-paying customers?

Take the steps necessary to keep the contents of your tanks secure.

One small, but important investment can greatly lessen your company's exposure to loss.



*Next Generation Saf-T-Lok #511
Shown here with RegO 9101R1
(not included)*

- Securely locks POL service valves
- Helps prevent unauthorized hookups
- Reduces pilferage
- Increases security
- No padlock required
- Simple to use
- Works exceptionally well at Cylinder Exchange locations

Consul

LP Gas Refrigerator

The 7.7 cubic foot Consul refrigerator requires no electricity, making it perfect for use in cabins, vacation homes and other remote locations, or as an emergency backup. It is quiet and reliable, with no moving parts. A safety gas shut-off and piezo igniter assure safe operation at the push of a button. AGA design certified.



Part #	Description
CB-2426	LP Gas Refrigerator, Global White

Teeco also carries a complete selection of Consul parts. Visit our website or consult the Teeco Master Catalog for detailed parts breakdown.

The Benefits of Going Tankless

Most North American consumers currently use storage tank water heaters to provide domestic hot water, using energy to keep water hot 24 hours a day, even while away from home or sleeping. However, a tankless water heater heats water only when it's needed, making it significantly more energy efficient than storage tank models. All models featured below are CSA approved and available in LP-Gas or Natural Gas.

Standing Pilot Units

ProTankless™ GWH-260-PN

This small gas tankless water heater is ideal for cottages, camps, and other specific applications where a small volume of hot water is desired. Compact size saves valuable floor space.

Features:

- Standing pilot ignition
- 74,900 btu/hr
- No electricity needed
- Mounts on wall for easy installation
- Compact and lightweight
- Modulating gas valve to control temperature
- Pressure relief valve included
- 15-year warranty



GW-260-PN

ProTankless™ GWH-425-PN

Provides endless hot water for one major application at a time

Features:

- Standing pilot ignition
- 117,000 btu/hr
- No electricity needed
- Modulating gas valve to control temperature
- Pressure relief valve included
- 15-year warranty



GW-425-PN

Hydro-Generated Unit

ProTankless™ GWH-425-HN

Patented Bosch Hydro-Generated Ignition Technology:

The pilot is ignited by a super-concentrated spark generated by a micro-turbine, which is activated by a request for hot water in the house. Energy efficient technology ideal for maximizing energy savings.

Features:

- Hydro-generated ignition
- No electricity needed
- 117,000 btu/hr
- Modulating gas valve to control temperature
- 15-year warranty



GW-425-HN

Electric Ignition Unit

ProTankless™ GWHC800ES

The new model offers a flow rate of up to 10 gpm, 92% efficiency, and the most advanced features in tankless technology, yet requires only 199,000 BTU/Hr input. It is designed to cascade for increased flow rates and will accommodate recirculating applications as well.

Features:

- 92% thermal efficiency - .90 energy factor
- Vents vertically or horizontally
- Condensing heat exchanger for maximum efficiency
- Outdoor installation using optional kit
- 15-year warranty



GWHC-800-ES

Part #	Description	Ignition	BTU/Hr Input	Capacity @ 45°F Rise	Energy Factor	Thermal Efficiency	Weight
GWH-260-PN-L	Tankless water heater, LP-Gas	Standing Pilot	74,900	2.6 gpm	.64	78%	25 lbs
GWH-260-PN-N	Tankless water heater, Natural Gas				.64		
GWH-425-PN-L	Tankless water heater, LP-Gas		117,000	4.25 gpm	.79	78%	33 lbs
GWH-425-PN-N	Tankless water heater, Natural Gas				.69		
GWH-425-HN-L	Tankless water heater, LP-Gas	Hydro-Generated	117,000	4.25 gpm	.80	78%	33 lbs
GWH-425-HN-N	Tankless water heater, Natural Gas				.80		
GWHC800ESLP	Tankless water heater, LP-Gas	Electronic	199,000	8.0 gpm	.90	92%	74 lbs
GWHC800ESNAT	Tankless water heater, Natural Gas				.89		

Teeco also offers a complete line of **ProTankless™** parts and accessories, such as Wireless Remotes, Pipe Covers, Horizontal Vent Kits, Outdoor Kits and more. Contact your Teeco branch or salesman or visit www.teecoproducts.com for more information.





Corporate Office
16881 Armstrong Avenue
Irvine, CA 92606



Presorted Standard
U.S. Postage
PAID
Newport Beach, CA
Permit No. 373

Customer Service Locations

Sacramento, CA
(800) 225-6621
FAX (888) 225-6621

Auburn, WA
(800) 426-9456
FAX (888) 426-9456

Rapid City, SD
(800) 843-8660
FAX (888) 843-8660

Order Online, Anytime: www.teecoproducts.com

Inside TEECO

What Is This Product?



Guess the name of this product - or how it's used - and we'll enter you in a drawing for a special prize. Email your answer to: **info@teecoproducts.com**,
Fax to: 949-474-8663, Attn: Marketing Dept.
or Snail-mail to : TEECO Products, Inc.
Attn: Marketing Dept.
16881 Armstrong Avenue
Irvine, CA 92606

Answer to last "What Is This Product?"

It is a MI-108 drop in needle. It is used to change the diameter of an orifice hood outlet when converting an appliance to LP Gas.

- Ruben Villavisencio, Pedley Propane



MI-108 Adapter Needle

This object is a drop in needle used to restrict gas flow through a range burner valve.

- Brad Foster, Turner Propane

It is a MI-108 Adapter Needle

- Pat Kuntz, Farmers Union Oil Co

This product is an Adapter Needle. It is part #MI-108 on page L13 (of the Teeco Catalog).

- Nanette Jorgensen, AmeriGas

Are You Ready for 2011?

2011 is getting closer. Teeco Products, Inc., with its quality product lines, engineering and fabrication services, is here to support the LP-Gas dealer in complying with NFPA 58 requirements.

REGC Master Distributor



Ask your Teeco Representative for a copy of **Teeco's 2011 Compliance Guide.**

www.teecoproducts.com

Your Partner in Meeting NFPA 58 Code Requirements for 2011 Compliance.